

**Rocky Point - 448,687sf**

Storage - 264,831 sf (59%)  
 Manfact - 128,375 sf (29%)  
 Office - 55,481 sf (12%)

Entire Facility available for lease for a blended rate of **\$3.50 psf NNN** or can be leased in separate sections.

**RP5 - 99,227 sf**  
 Storage - 99,227 sf (100%)  
 Manfact - 0 sf (0%)  
 Office - 0 sf (0%)  
**\$4.00 psf NNN**

**RP4 - 96,647 sf**  
 Storage - 25,599 sf (26%)  
 Manfact - 68,015 sf (70%)  
 Office - 3,033 sf (4%)  
**\$3.50 psf NNN**

**RP3 - 8,119 sf**  
 Storage - 8,119 sf (100%)  
 Manfact - 0 sf (0%)  
 Office - 0 sf (0%)  
**\$3.75 psf NNN**

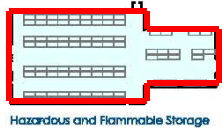

**RP2 - 98,934 sf**  
 Storage - 0 sf (0%)  
 Manfact - 60,360 sf (61%)  
 Office - 38,574 sf (39%)  
**\$4.00 psf NNN**

**RP1 - 145,760 sf**  
 Storage - 131,886 sf (90%)  
 Manfact - 0 sf (0%)  
 Office - 13,874 sf (10%)  
**\$2.75 psf NNN**

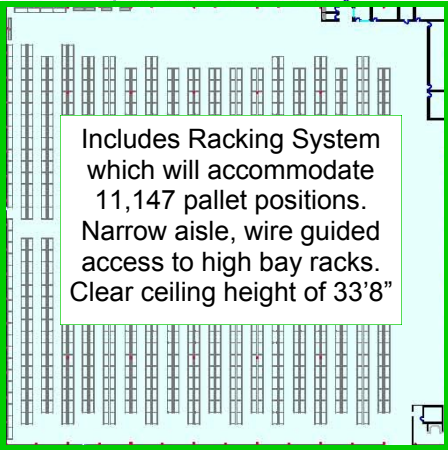

- Storage & Shipping
- Manufacturing
- Office & Common

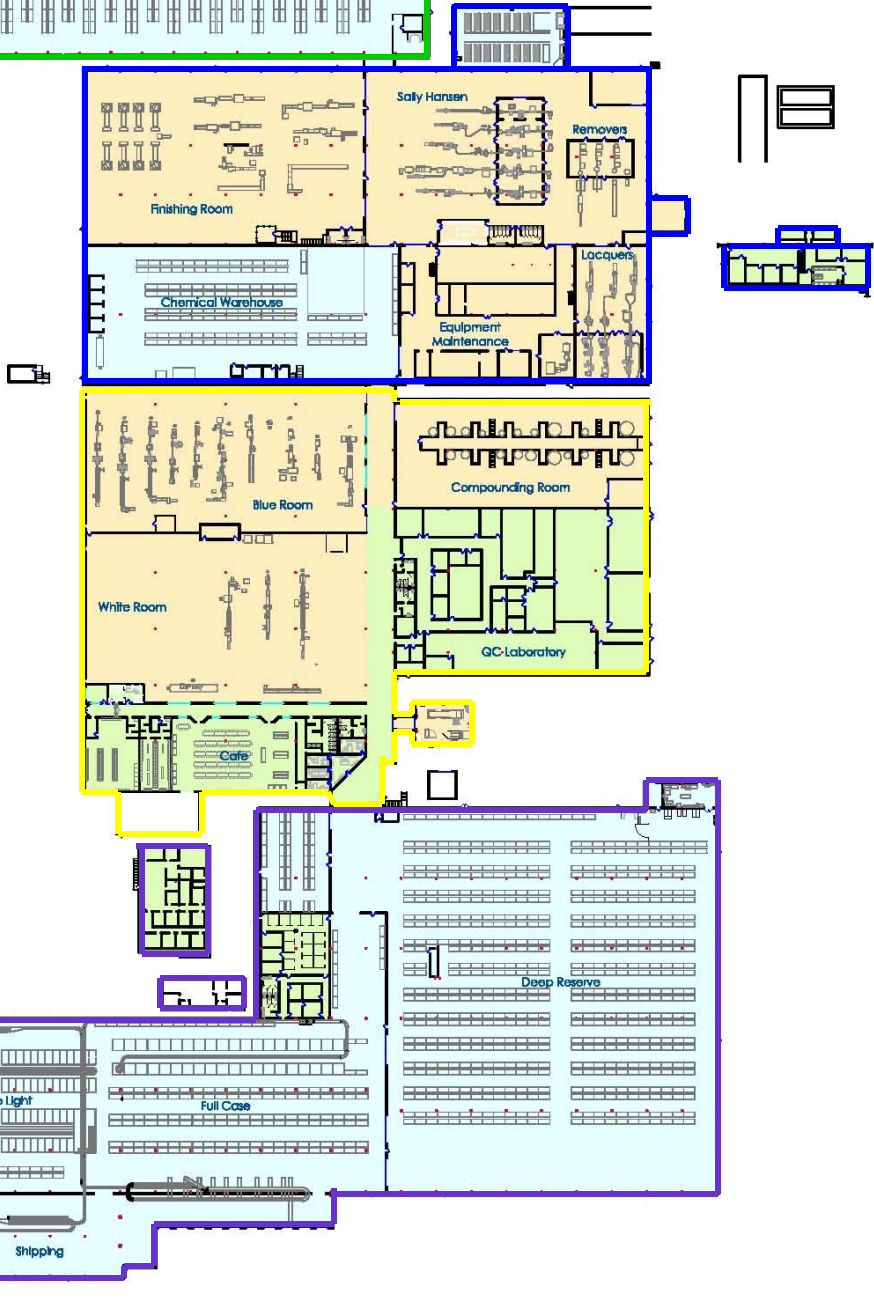

**Cape Fear Industrial Complex**

Scale
nts
Page
1 of 1